

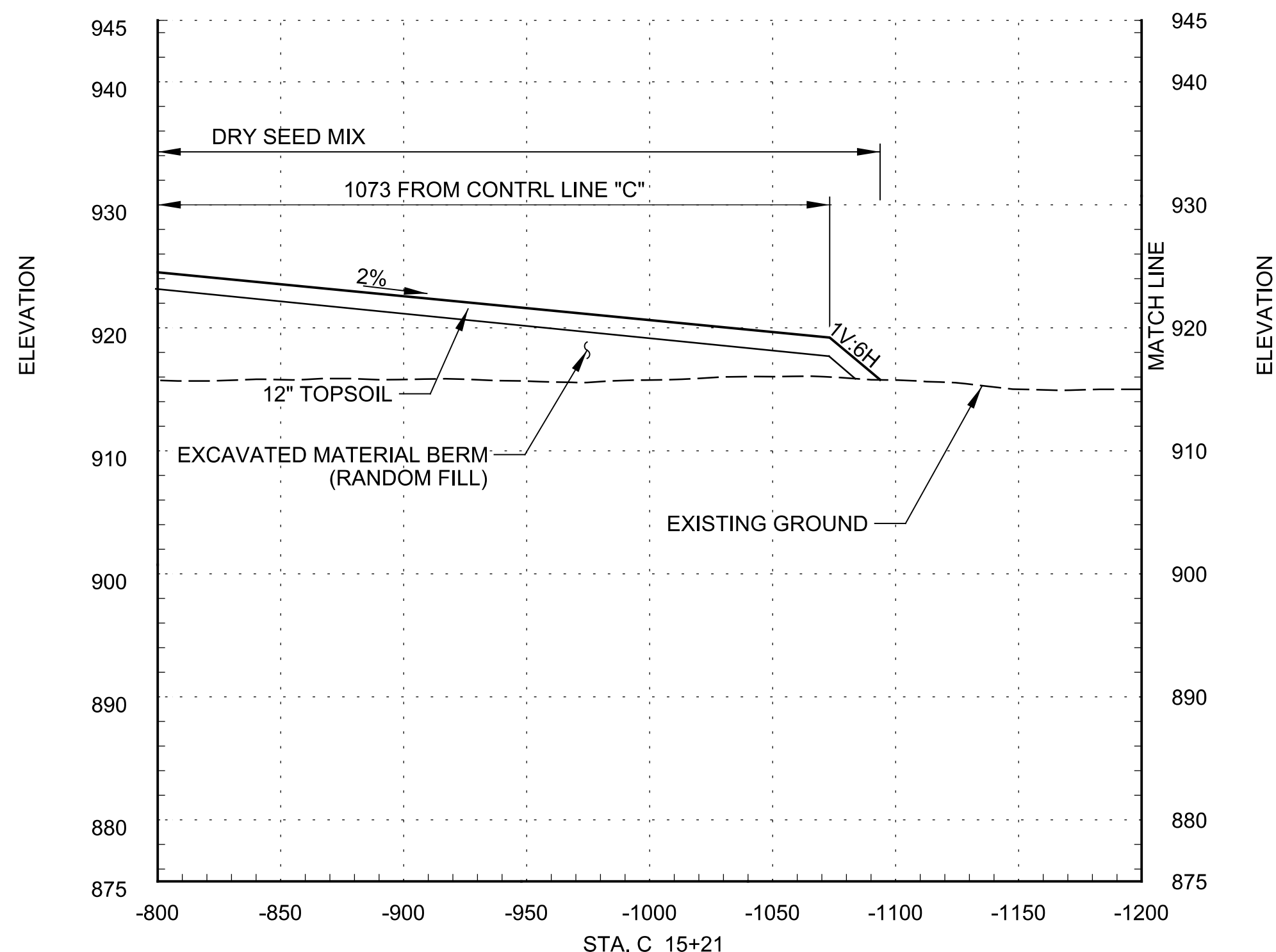

US Army Corps of Engineers

GENERAL NOTES:

1. PROVIDE RIPRAP AND BEDDING WITHIN LIMITS INDICATED ON SHEET CS402 AND SHEET CS201.
2. SEE SHEET CS201 FOR CHANNEL PROFILE AND RT DAM EMBANKMENT PROFILE.
3. SEE STRUCTURE SHEETS FOR FOUNDATION SLAB DETAILS.
4. SEE SHEET CS505 FOR SLOPE PAVING DETAILS.



D
CS101 **TYPICAL SECTION (CONT.)**
STA. C 13+02.43 TO STA. C 15+59.52

HORIZONTAL SCALE 0 25' 50' 100'
VERTICAL SCALE 0 10' 20'

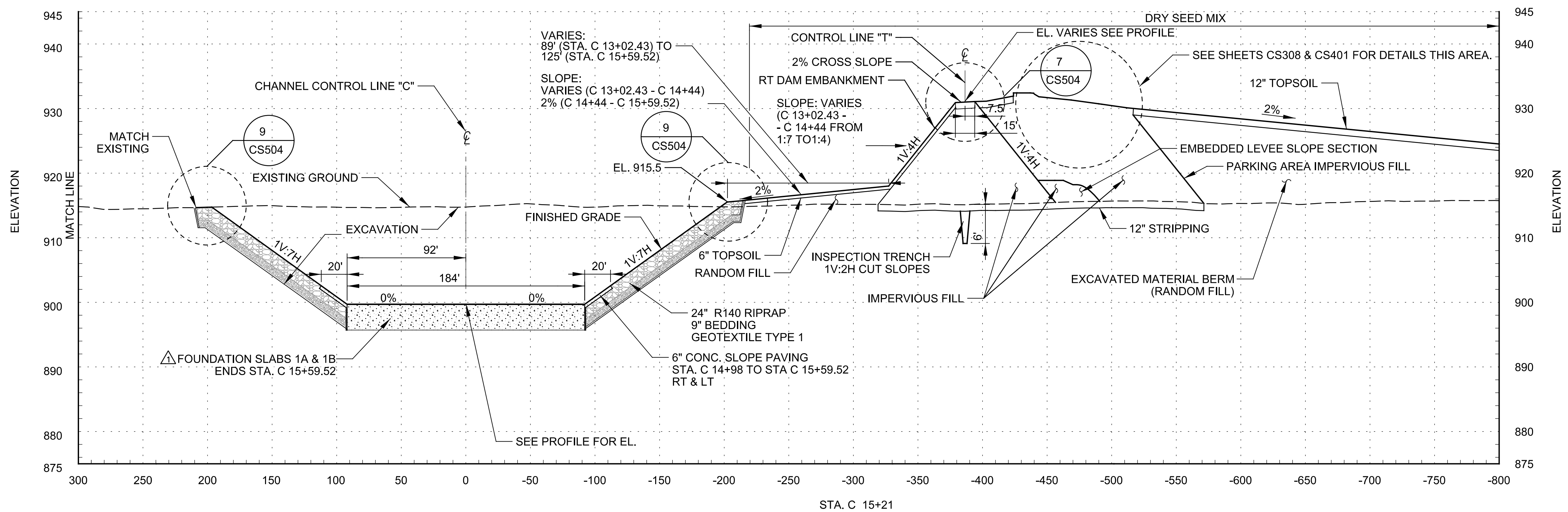

D
CS101 **TYPICAL SECTION**
STA. C 13+02.43 TO STA. C 15+59.52

HORIZONTAL SCALE 0 25' 50' 100'
VERTICAL SCALE 0 10' 20'

ELEVATION DATUM (VERTICAL CONTROL): COORDINATE SYSTEM (HORIZONTAL CONTROL):
NAVD 88 NAD 83 (2011)
GEOID12A ND SPCS, SOUTH ZONE-U.S. SURVEY FT.
COMBINED FACTOR (CF): 0.999956276

MARK	DESCRIPTION	DATE	APPR.	MARK	DESCRIPTION	DATE	APPR.
1	DWG REVISION WITH AMENDMENT NO. 0003	JULY 2016					

DESIGNED BY: U.S. ARMY CORPS OF ENGINEERS	CHECKED BY: RFJ	DATE: 7/26/2016	CONTRACT NO.:
DRAWN BY: T. SULLY	SCALE: 1" = 50'	FILE NAME: FMADIE_CS300xxx.dgn	FILE NUMBER:
PROJECT LOCATION: ST. PAUL DISTRICT ST. PAUL, MINNESOTA			

FMM DIVERSION INLET STRUCTURE
RED RIVER OF THE NORTH RIVER BASIN
FARGO-MOORHEAD FLOOD RISK MANAGEMENT
FARGO, ND
TYPICAL SECTIONS
4 OF 10

Sheet ID
CS304